

- 1 The elastic strap should be adjusted to the size of the upper arm of the wearer. One side of the elastic strap has already been fitted into the sensor.

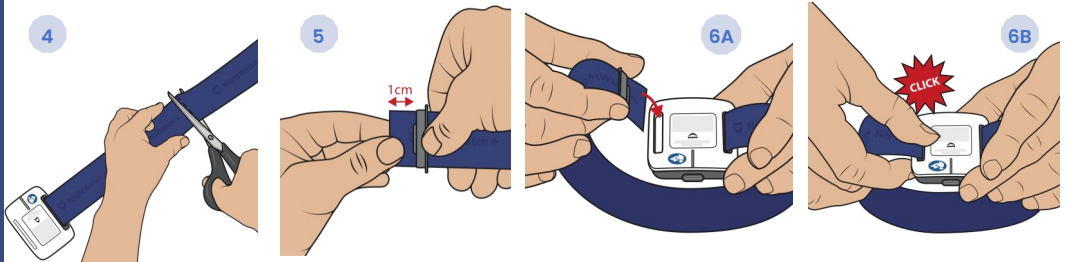

- 2 Use the remaining end of the elastic strap to measure the circumference of the wearer's arm above the biceps in a bent position. Do not stretch the strap.
- 3 Then mark the strap where it overlaps the empty sensor clip entrance.



- 4 Cut the strap on the marked location.
- 5 Attach a clip to the remaining end of the strap by pushing one corner of the elastic strap through the flat side of the clip. Pull the strap through the clip until it sticks out at a length of around one centimeter.
- 6 Push the clip into the remaining slot of the sensor with the end of the strap protruding from the bottom of the sensor.

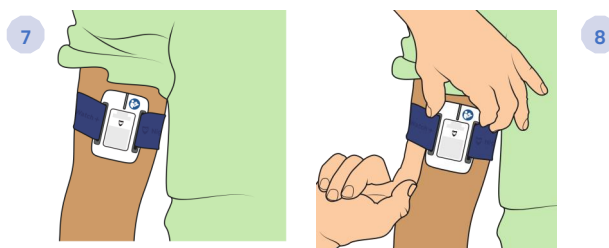

- 7 Place the sensor around the wearer's upper arm on the front of the biceps, not to the side. This ensures that the wearer is unlikely to lie on the sensor when turning onto his/her side. Lying on the sensor could disrupt tracking the heart rate.
- 8 The fit should be comfortably tight, still allowing for one finger underneath the strap.

Your NightWatch+ contains comfort patches that optimize comfort while wearing the sensor. This guide explains how to apply the comfort patch.

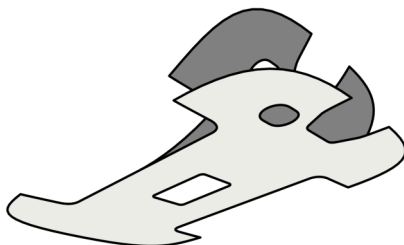
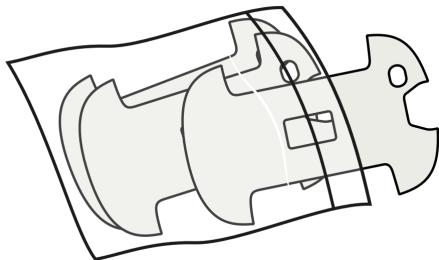

Remove the paper on the bottom of the patch and stick it over the dark underside of the NightWatch sensor. Use the middle hole and opening for the on/off switch as position guides as shown in the figure below.

- Make sure that the charging port remains free for charging.
- Make sure that the on/off switch of the arm module remains free.
- Make sure the patch does not cover the black sensor area in the middle.

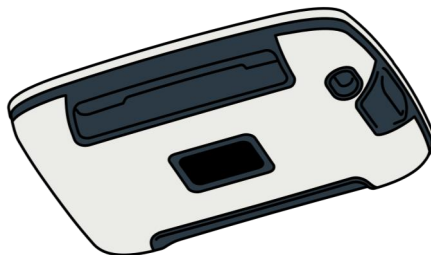
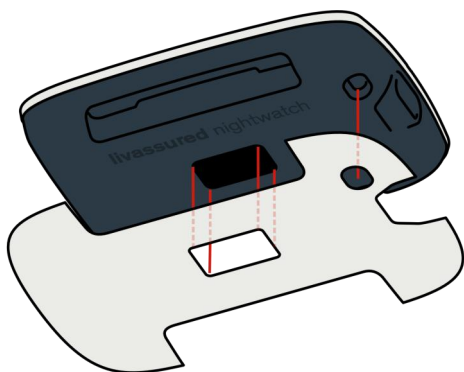

Replace the patch if it starts to become dirty, damaged or loose. Comfort patches are commonly replaced after one month. Replacement patches can be ordered on our website or via [info@nightwatchepilepsy.com](mailto:info@nightwatchepilepsy.com).

More details on the usage of the NightWatch+ can be found in the user manual. Email [helpdesk@nightwatchepilepsy.com](mailto:helpdesk@nightwatchepilepsy.com) with any queries or problems.